

HAW
RTMENT

Waxhaw, N.C 28173
Phone: 704) 843-2196
Hours: M-F / 8-5

12/1/22

Addendum 2

1. **REPLACE SP-4 TRENCHLESS INSTALLATION OF UTILITIES - FREE BORE**, of Union County Water Special Provisions, beginning on page 64 of the Bidding Requirements and Contract Documents, with the following:

SP-4 TRENCHLESS INSTALLATION OF UTILITIES - FREE BORE

Page 15-20, Article 1550-4(A) Bore and Jack, replace lines 36 thru 39, with the following:

For bore holes up to 12 inches in diameter in stable ground, the hole may be augured and the pipe pushed or jacked through the cleaned out hole. Price for Free Bore does not include the price of pipe. Pipe will be paid under the appropriate unit price for Water Pipe.

SP-4-1 MEASUREMENT AND PAYMENT

Bore and Jacking of 6" DIP Water Pipe will be measured and paid in linear feet between the bore pit and receiving pit at the depth of bore. Measurement will be made horizontally along the centerline of pipe to the nearest linear foot.

2. Question-Item 90, Bore and Jacking of 6" DIP Water Pipe, appears to cover the "Free Bore" past the utility poles and tree located along N. Providence Street. Is that correct? Answer- Correct.
 3. Question-SP-4 mentions bore holes up to 12 inches in diameter. Will the 6" DIP Water Pipe that is bored along N. Providence Street be installed in 12" encasement pipe? How will the encasement pipe be paid? Answer-Bore holes in SP-4 are to be free bores without encasement pipe. The unit price covers only the bore holes. Pipe inserted into bore holes will be paid as if installed by conventional trenching methods.
 4. Question-If pavement repair is to be included in the items for Connection to Existing Water lines, items 87-89, what are the limits along the proposed waterline that pavement repair is to be included in these line items?
-

Answer-Limits for payment for pavement repair will be determined as defined in "SP-2 Asphalt Plant Mix". In order to provide adequate work space in the trench, measurement will be made along the water lines to a "reasonable" distance beyond the connection points as measured along the existing water pipe. The distance beyond each connection point will be subject to the depth of the existing water line.

5. **Plan Sheet E 1.0-Electrical Plan** has been revised to update the Pole Schedule and the Plan Specific Notes.
6. Question- The pavement schedule on sheets 2A and 2B have different thicknesses for E1, D1, & C1. Please clarify. Answer- Use the pavement schedule on 2A for the project. Some clarification on C1- S9.5B
 - 1.5" is to be used on the mill and overlay surface.
 - 3" = (2) x 1.5" lifts is to be used for the full depth pavement.
7. Question- Is the Contractor performing the final surface of 1.5" Asphalt Concrete Surface Course across the widening and milling (resurfacing) limits of the project? Answer-Yes
8. Question- The Project Special Provisions for Trenching for Base Course and Intermediate Course state "All trenching for asphalt base course shall be by use of an approved milling machine." Will the Town allow the Contractor to sawcut, excavate and grade the trenches/widenings by use of other equipment besides a milling machine? (i.e., excavator, backhoe, etc.) It will potentially be costly and inefficient if the Contractor is required to use a milling machine for this scope. Answer-We will approve that for Town rights of way, this would be a pre-construction item on NCDOT facilities.

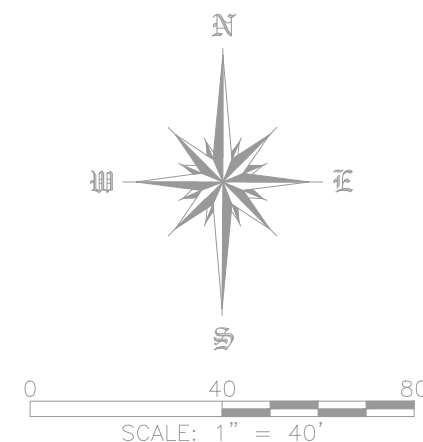

GENERAL NOTES

1. ALL INSTALLATIONS SHALL CONFORM TO THE LATEST EDITION OF THE NATIONAL ELECTRICAL CODE AS WELL AS ALL APPLICABLE STATE AND LOCAL CODES.
2. ALL ELECTRICAL EQUIPMENT AND DEVICES SHALL BE SUITABLE FOR ITS APPLICATION PER THE LISTING INSTRUCTIONS OF A NATIONALLY RECOGNIZED AND APPROVED TESTING LABORATORY.
3. LOCATION OF NEW LIGHTS/LIGHT POLES TO BE IN SAME LOCATION AS EXISTING BEING REMOVED.

PLAN SPECIFIC NOTES

1. NEW LIGHTING UNITS WITH INTEGRATED POLE MOUNTED RECEPTACLE TO BE INSTALLED IN SAME PLACE AS EXISTING/REMOVED LIGHTING UNITS. EXISTING CONDUIT AND WIRING MAY BE REUSED IF FOUND TO BE IN GOOD WORKING ORDER. IF FOUND TO BE IN NON-WORKING ORDER, CONTRACTOR SHALL REPLACE WITH NEW CONDUIT AND WIRING MATCHING EXISTING SIZING. LOAD ON CIRCUIT TO BE REDUCED DUE TO THE NEW FIXTURES BEING A LESSER LOAD ON THE CIRCUIT. REFER TO "STREET LAMP SCHEDULE" FOR FIXTURE/POWER SOURCE INFORMATION. REFER TO POLE BASE DIAGRAM FOR ADDITIONAL INFORMATION. REFER TO POLE SCHEDULE FOR INFORMATION ON CAMERA AND WIFI CONNECTION CONFIGURATION.
2. EXISTING CONDUIT AND WIRING TO BE REUSED IF FOUND TO BE IN GOOD WORKING ORDER. IF FOUND TO BE IN NON-WORKING ORDER, CONTRACTOR SHALL REPLACE WITH NEW 2" CONDUIT AND WIRING MATCHING EXISTING SIZING. CONTRACTOR TO PROVIDE NEW CONDUITS AND WIRING TO PROVIDE POWER TO NEW POLE MOUNTED RECEPTABLES. REFER TO PANEL SCHEDULE FOR WIRE SIZE AND RECEPTACLE LOADS. REFER TO STREET LAMP SCHEDULE FOR REQUIRED BURIAL DEPTH OF NEW CONDUITS.
3. INSTALL NEW 2" UNDERGROUND CONDUIT (WITH PULL STRING) FOR TELECOM CABLE/SYSTEM. TO BE INSTALLED AT SAME DEPTH AS POLE ELECTRIC SERVICE. REFER TO THE STREET LAMP SCHEDULE FOR ADDITIONAL INFORMATION.
4. PROVIDE AND INSTALL NEW, GROUND-MOUNTED HAND-HOLE, DIRECTLY BEHIND EACH POLE FOR USE BY TELECOM SYSTEM. EXTEND EMPTY 1" CONDUIT FROM HAND-HOLE OVER TO LIGHT POLE BASE. HAND-HOLE TO BE 12"x12"x12" WITH TRAFFIC-RATED COVER.
5. PROVIDE AND INSTALL NEW, GROUND-MOUNTED HAND-HOLE, FOR USE BY TELECOM SYSTEM. EXTEND EMPTY 2" CONDUIT FROM HAND-HOLE, OUT TO THE SMALLER HAND-HOLES LOCATED BEHIND EACH LIGHT POLE BASE. HAND-HOLE TO BE 18"x24"x18" WITH TRAFFIC-RATED COVER.
6. NEW FIBER TO BE PROVIDED BY OTHERS. CONTRACTOR TO PROVIDE NEW 2" CONDUIT WITH PULL STRING FOR NEW FIBER TO BE INSTALLED. COORDINATE EXACT REQUIREMENTS WITH OWNER AND OWNER'S REPRESENTATIVE PRIOR TO BEGINNING INSTALLATION OR ANY SITE WORK.
7. PROVIDE 2" CONDUIT/FIBER (WITH PULL STRING) TO BE BORED UNDER DRIVE/PAVEMENT FOR CONTINUATION OF CIRCUIT/LINE. COORDINATE EXACT REQUIREMENTS WITH OWNER AND OWNER'S REPRESENTATIVE PRIOR TO BEGINNING INSTALLATION OR ANY SITE WORK.
8. PROVIDE NEW NEMA 3R RATED OUTDOOR CABINET ENCLOSURE TO HOUSE FIBER AND NETWORKING EQUIPMENT. CABINET TO BE AN 18u, 24" DEEP FLOOR STANDING ENCLOSURE, OR WALL MOUNTED ENCLOSURE WHERE INDICATED. PROVIDE MODELS AS APPROVED BY OWNER. CONTRACTOR TO COORDINATE CLOSELY WITH OWNER FOR REQUIREMENTS PRIOR TO ORDERING EQUIPMENT. PROVIDE AND INSTALL A GFCI-TYPE DUPLEX RECEPTACLE IN WATERPROOF BOX/COVER TO POWER TELECOM EQUIPMENT. REFER TO PLANS FOR CIRCUIT INFORMATION TO RECEPTACLE.
9. INSTALL NEW 2" UNDERGROUND CONDUIT (WITH PULL STRING) FOR TELECOM CABLE/SYSTEM. TO BE INSTALLED AT SAME DEPTH AS POLE ELECTRIC SERVICE. REFER TO THE STREET LAMP SCHEDULE FOR ADDITIONAL INFORMATION.

TOWN OF WAXHAW - POLE SCHEDULE
PHASE EB-5819

POLE #	CAMERA	LOGO	BANNER ARM	WIFI
10	X	X		
11			X	X
12	X		X	
13			X	
14		X	X	

NOTES:
CONTRACTOR TO COORDINATE EXACT POLE CONFIGURATIONS WITH THE TOWN OF WAXHAW PRIOR TO INSTALLATION OF ANY EQUIPMENT.

PHASE EB-5819 - STREET LAMP SCHEDULE					
LAMP ID	INSTALLATION	POWER SOURCE	PROPOSED METER	PROPOSED PANEL	PHASE
10	BOLTED	POWER POLE 3	ON POLE 3	PANEL P3	1
11	BOLTED	POWER POLE 3	ON POLE 3	PANEL P3	1
12	BOLTED	POWER POLE 3	ON POLE 3	PANEL P3	1
13	BOLTED	POWER POLE 3	ON POLE 3	PANEL P3	1
14	BOLTED	POWER POLE 3	ON POLE 3	PANEL P3	1

CONTRACTOR TO COORDINATE CLOSELY WITH OWNER AND OWNER'S REPRESENTATIVE FOR EXACT MOUNTING OF FOUNDATION/BASE PRIOR TO ROUGH-IN.

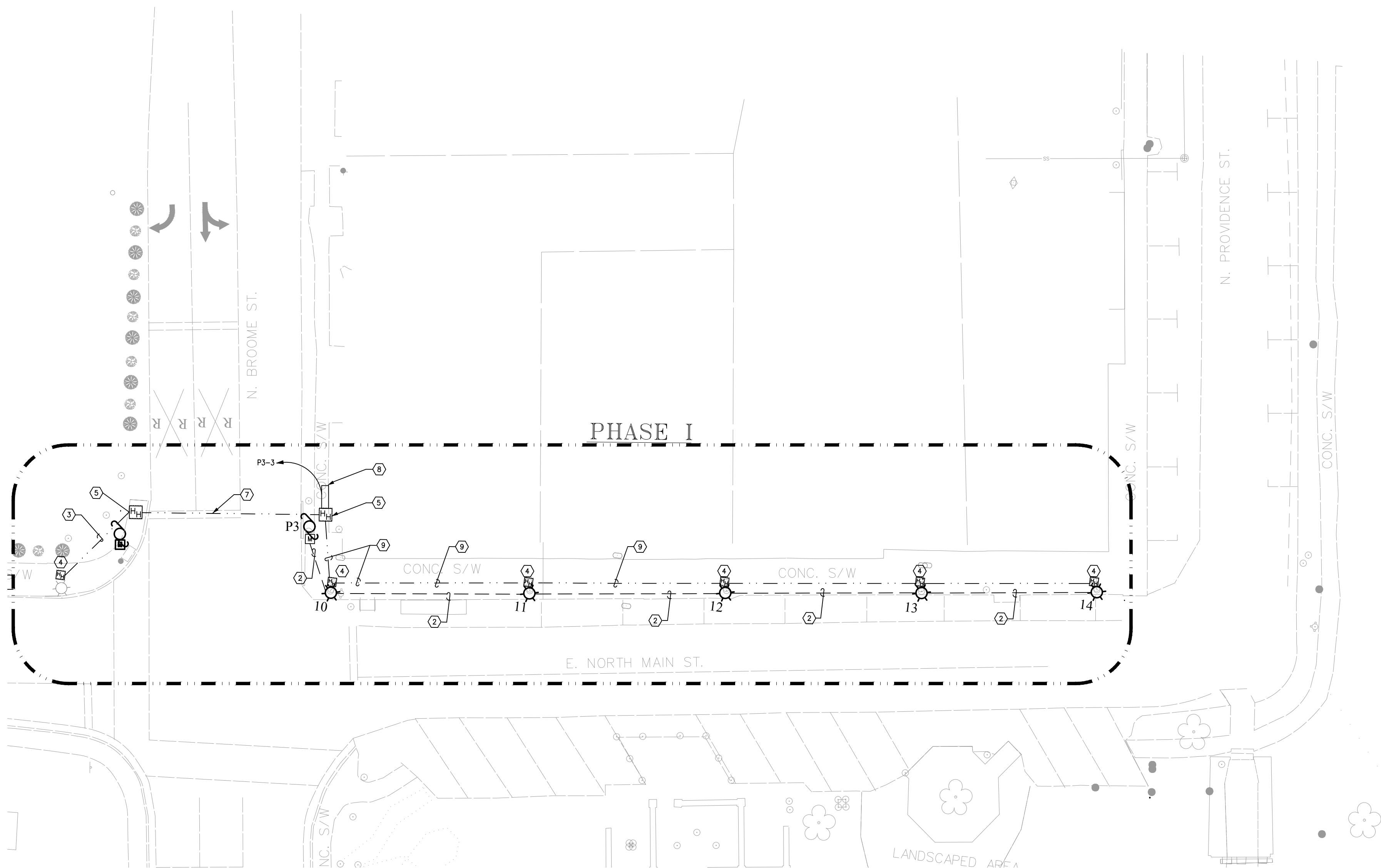

- 1 6/1/22 - NCDOT REVIEW COMMENTS
- 2 11/30/22 - ADDENDUM #2



SHULTZ
ENGINEERING
GROUP, PC

212 N. McDowell St., Suite 204
Charlotte, NC 28204
(P) 704.334.7363 | (F) 704.347.0093
www.shultzeg.com | SEG - 22-040
NC FIRM LICENSE NUMBER: C-0898

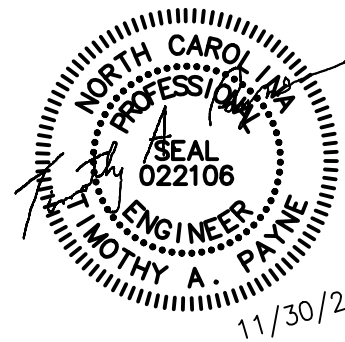

Date	03.30.22	03.30.22	03.30.22
Designed	RR / TP	RR / TP	TP
Drawn			
Checked			
Approved			

EB-5819

Town of Waxhaw
DEVELOPMENT SERVICES DEPARTMENT
P.O. BOX 617
1150 NORTH BROOME STREET, WAXHAW, N.C. 28173
TELEPHONE (704) 843-2195, FAX (704) 243-3276
HOURS: MONDAY-FRIDAY 8:00 A.M. TO 5:00 P.M.



File Name

Drawing Name
ELECTRICAL
PLAN

Sheet
E1.0
of